

1

2

3

4

5

6

A

A

B

B

C

C

D

D

PRODUCTION

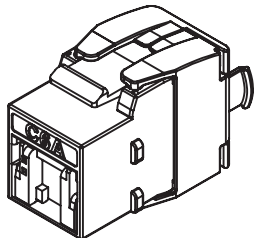
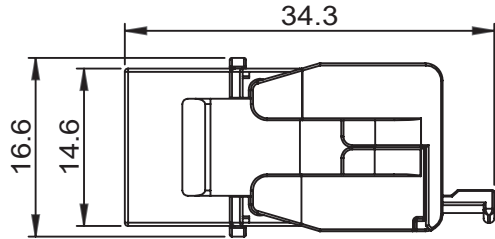

SUGGESTED MOUNTING CUTOUT

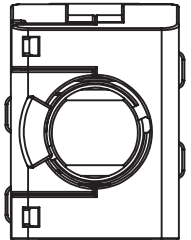
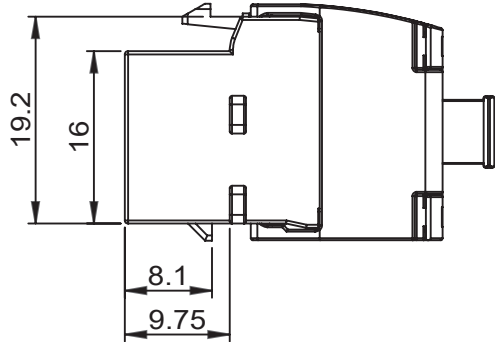
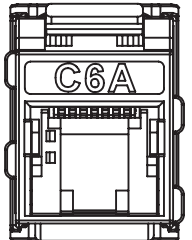
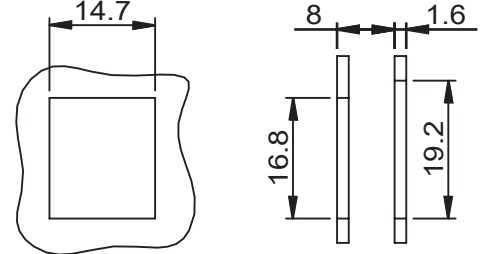

ACCORDING TO : ANSI/TIA-568-C.2
ISO/IEC 11801 2nd Edition
IEC 60603-7

MATERIAL

BRACKET : NICKEL SILVER ALLOY.
KEYSTONE JACK HOUSING : ZINC ALLOY,NICKEL PLATED.
REAR HOUSING : ZINC ALLOY,NICKEL PLATED.
KEYSTONE JACK LATCH : PC+ABS,UL94V-0.
CONTACT HOLDER : PC,UL94V-0.
SHUTTER : PC,UL94V-0.
SPRING : SUS304 .
JACK CONTACTS : PHOSPHOR BRONZE,50U" GOLD PAINTING.
IDC PLASTIC : PC,UL94V-0.
IDC TERMINALS : PHOSPHOR BRONZE,TIN OVER NICKEL UNDERCOAT.

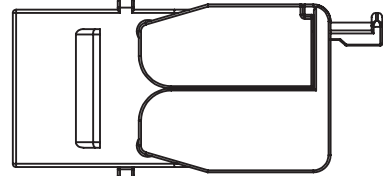

ENCLOSURE
IDC CAP X 1 PC



COMMUNICATION
CIRCUIT ACCESSORIES

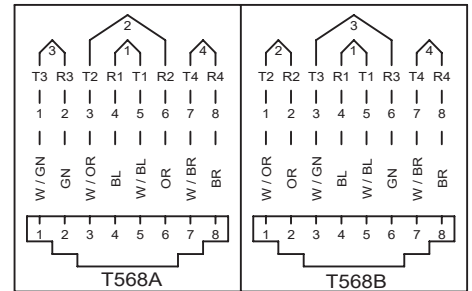

PHYSICAL CHARACTERISTICS

INSERTION LIFE : 750 MATING CYCLES WITH FCC COMPLIANT 8P PLUG.
CONTACT FORCE : 100 GRAMS WITH FCC COMPLIANT 8P PLUG.
PLUG RETENTION FORCE : 11 LBF MIN.
DURABILITY : 30 TERMINATION CYCLES.
CONTACT COMPATIBILITY : ACCOMMODATES 22 TO 24 AWG SOLID.
OPERATING TEMPERATURE RANGE : -10°C TO 60°C.
STORAGE TEMPERATURE RANGE : -40°C TO 68°C.
HUMIDITY : 10%-90%RH.

ELECTRICAL

INSULATION RESISTANCE : 500 MΩ.
DIELECTRIC WITHSTANDING VOLTAGE : 1000 V AC.
DC CURRENT RATING : 1.5 Amps.
DC RESISTANCE : 0.1Ω.
CONTACT RESISTANCE : 20mΩ.

NOTE

* ONLY ACCEPT RJ-45 8P8C PLUG.

GENERAL TOLERANCE OF DIMENSIONS X.XXX ±0.005 X.XX ±0.05 X.X ±0.1	DRAWING	14.JUN.2016	QIQI	KUWES
	CHECK	14.JUN.2016	JANE	
	APPROVAL	14 JUN 2016	JAIMY	
	DATE		NAME	
SCALE	1/1 (A4)	UNIT	mm	DES.: CAT.6A FULL SHIELDED KEYSTONE JACK
DRAWING NO.		DRAWING CLASSIFICATION		
DRAWING CLASSIFICATION		S	SHEET	1 OF 1

1

2

0

3

4

10cm

5

6

